

# MOGORA COSMIC PVT LTD.

LEADING MANUFACTURER AND EXPORTER OF INVERTER BASED  
ARC / TIG / MIG / SAW WELDING MACHINES AND WELDING SIMULATORS

**INTRODUCES**

**INTERNATIONAL QUALITY MIG AND TIG WELDING TORCHES**

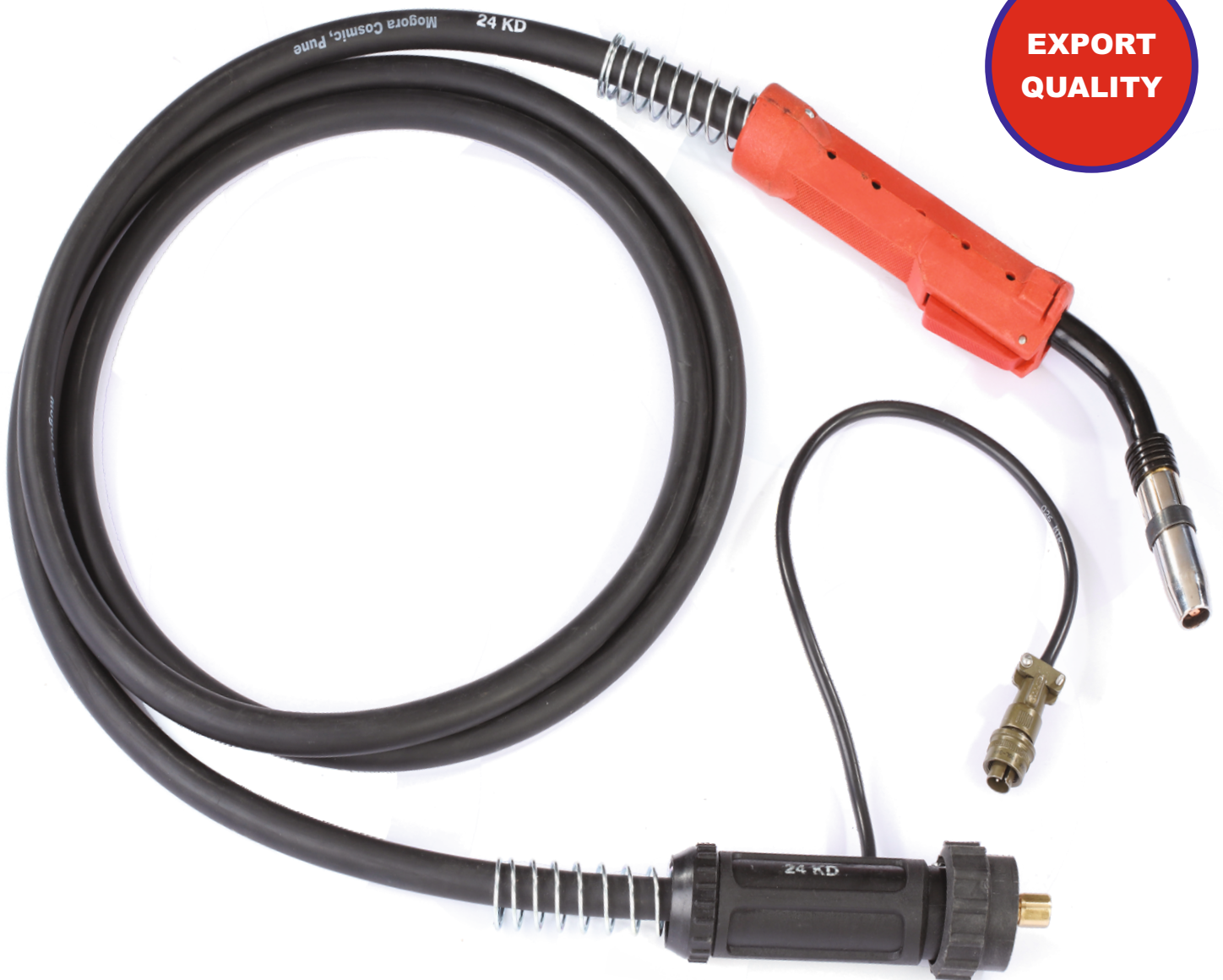

**Model : 24 KD**  
**250 Amps @**  
**60% Duty Cycle**  
**GAS COOLED**

**Model : 36 KD**  
**400 Amps @**  
**60% Duty Cycle**  
**GAS COOLED**

Catalogue Number . : MCPL/T/062017/A



## MOGORA COSMIC PVT LTD.

EL 31/16, ELECTRONIC ZONE, PIMPRI INDUSTRIAL AREA, M.I.D.C.,  
BHOSARI, PUNE - 411026. MAHARASHTRA, INDIA

PHONE : +91 20 66123806, 66123807

EMAIL : [info@mogora.com](mailto:info@mogora.com), [sales@mogora.com](mailto:sales@mogora.com) WEB SITE : [www.mogora.in](http://www.mogora.in)

# SPARE PARTS LIST

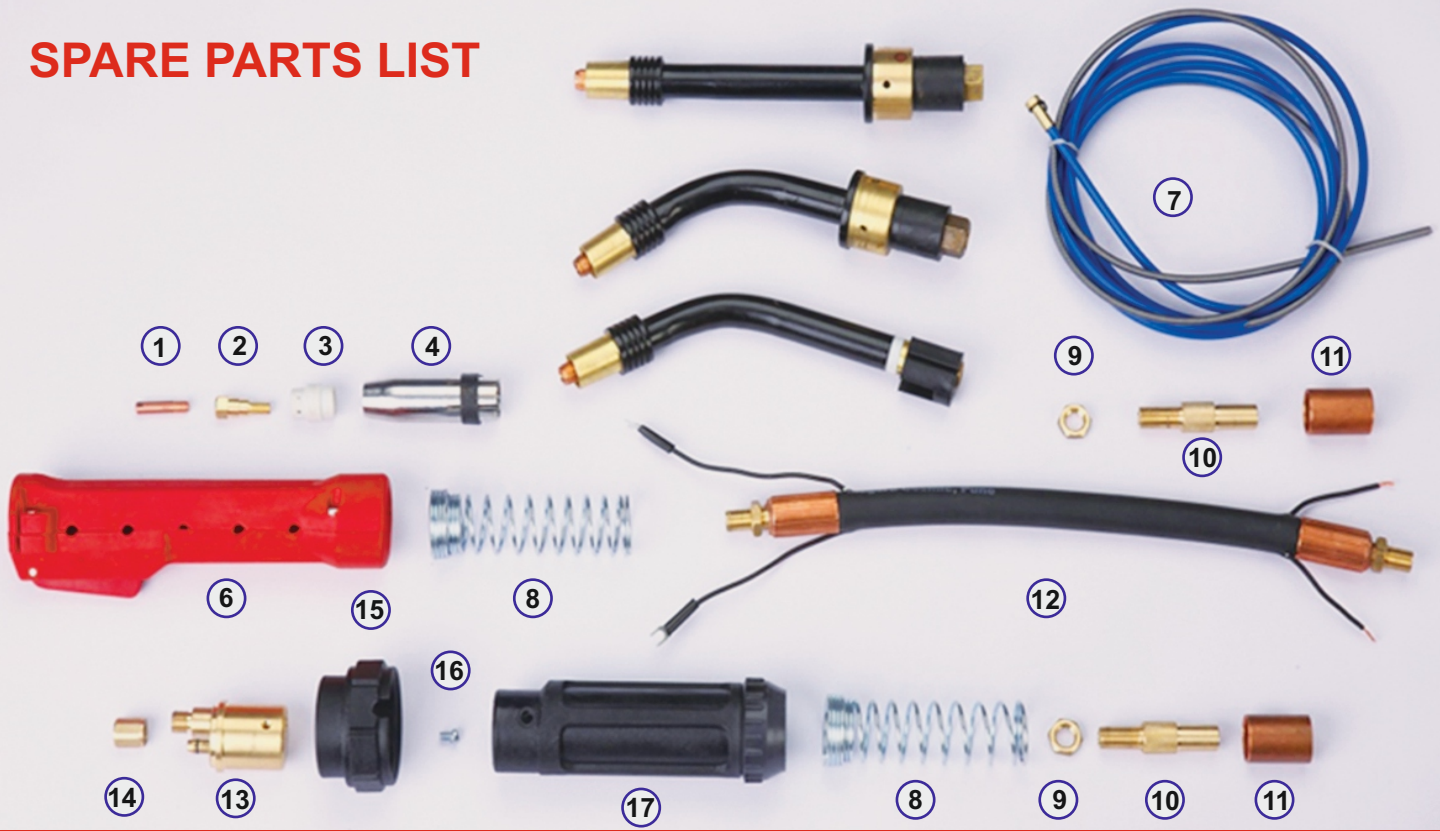

NO.	DESCRIPTION		PART NO (24 KD)	PART NO (36 KD)	
1	CONTACT TIP	a	0.8 MM	MT2017A2401	MT2017A3601
		b	1.2 MM	MT2017A2401A	MT2017A3601A
2	TIP HOLDER		MT2017A2402	MT2017A3602	
3	DIFFUSER		MT2017A2403	MT2017A3603	
4	NOZZLE	a	STANDARD	MT2017A2404	MT2017A3604
		b	TAPERED 10MM BORE	MT2017A2404A	MT2017A3604A
5	SWAN NECK	a	45° STANDARD - MANUAL	MT2017A2405	MT2017A3605
		b	45° - SPM	MT2017A2405A	MT2017A3605A
		c	180° - SPM	MT2017A2405B	MT2017A3605B
6	HANDLE ASSEMBLY	a	RED - PVC (STANDARD)	MT2017A2406	MT2017A3606
		b	STEEL HANDLE (SPM)	MT2017A2406A	MT2017A3606A
7	LINER		MT2017A2407	MT2017A3607	
8	CABLE SUPPORT - SPRING		MT2017A2408	MT2017A3608	
9	LOCK NUT - 10 X 1		MT2017A2409	MT2017A3609	
10	BRASS FERRULE		MT2017A2410	MT2017A3610	
11	COPPER FERRULE		MT2017A2411	MT2017A3611	
12	POWER CABLE ASSEMBLY	a	STANDARD 3.0 MTR LENGTH	MT2017A2412	MT2017A3612
		b	SPM 1.0 TO 3.0 MTR (AS REQUIRED)	MT2017A2412A	MT2017A3612A
13	BRASS ADAPTOR		MT2017A2413	MT2017A3613	
14	LINER POSITIONER NUT		MT2017A2414	MT2017A3614	
15	ADAPTOR NUT		MT2017A2415	MT2017A3615	
16	ADAPTOR SUPPORT LOCK SCREW	a	FILISTER HEAD SCREW M4 X 8 MM	MT2017A2416	MT2017A3616
		b	COUNTER SUNK SCREW M4 X 6 MM	MT2017A2416A	MT2017A3616A
17	ADAPTOR SUPPORT		MT2017A2417	MT2017A3617	

TO ORDER, PLEASE MENTION TORCH MODEL, PART NO. AND QUANTITY

e.g. : FOR 1.2mm CONTACT TIP : 24 KD, MT2017A2401, 100 NOS.